



PHASE V RESTORATION UPDATE



September 22, 2023

HAPPY FALL Y'ALL!

Weekly progress meetings including the owner project manager, architect, construction team, and the Tabernacle Restoration Committee (TRC) have begun and will continue through project completion.

The Tabernacle@mvcma.org email address should be used to provide feedback or ask questions related to the project. The TRC will do our best to respond to questions received in future public communications, so that everyone remains equally accessible to the same information.

All details provided remain *subject to change*.

Schedule Highlights

2023

- Current Carpentry work including mockup of wood blocking and sistering of purlins.
- Next Week: Arrival of roof tiles on site!
- Oct 2: Mockup of roof tiles and all roof features to begin. This will include abatement work.
- Oct 11: Continuation of roof replacement based on approval of mockup by architect.

2024

- Jan 3: Roof work is scheduled to be completed.
No major work is planned during January and February, based on potential weather and environmental (temperature) conditions.
- Mar 1: Painting of structure in place begins.
- Mar 4: Electrical rough-in begins.
- Apr 1: Stage modification and ADA lift installation begins.
- May 6: De-mobilization begins.
- May 17: Restoration of Site; "Substantial Completion" due (per contract)
- May 31: Last day available for construction work, with limited exceptions
- June 9: MVRHS Graduation (tentative)

Site Area Expansion / Roof Tiles

The roof tiles have arrived in the USA and are currently in the possession of the roofing subcontractor, Capeway ([Capeway Roofing Systems, Inc.](http://www.capewayroofing.com)). It is expected that they will be delivered to the site next week, pending ferry reservations.

To allow for these materials to be stored as close to the Tabernacle as possible, the TRC and TRAC are reviewing opportunity to expand the site area to provide more ground space to store them inside Trinity Park. This expansion would likely be above the path to Pawtucket and below the path to Pleasant Lane.

Protection Efforts

Thankfully, Hurricane Lee brought much less wind and rain to the Island than forecasted, although there was enough impact to knock down a few dozen sections of fencing. TRAC and B&G crew were on site Saturday morning picking up the fence. No other known issues occurred. *(Photos courtesy of TRAC).*

The cabling system will remain in place for the duration of the off season. The general contractor (TRAC) was part of the installation process to learn how it works, as they will need to detach and reattach cables as they work around the roof.

Trees and landscaping have been protected in coordination with Hagerty Tree Services. If the site area increases, additional protections will be put in place for landscaping within the new perimeter.

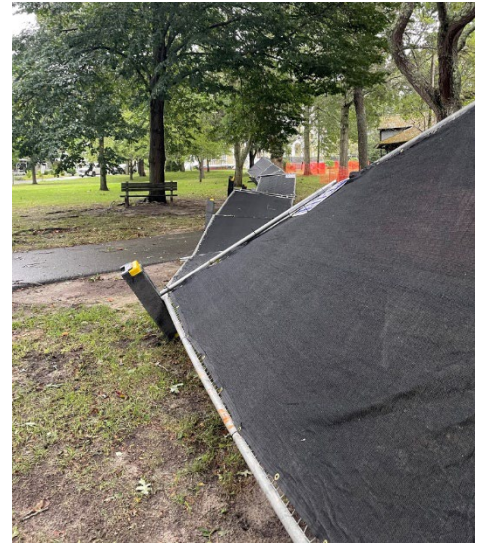

The Tabernacle benches are in the process of being protected in place for the duration of construction. A system of scaffolding is being built over the benches to ensure no damage occurs. This structure will be supported by dimensional lumber and have a layer of foam between the plywood covering and the bench seat backs. No portion of this protection structure is being secured into the benches themselves.

A box-like structure will be built around the glass lantern lighting fixtures to protect them. Plywood will also be secured over the stained-glass windows prior to work commencing in that area.

Focus and discussion will be highlighted and documented throughout the project to ensure that proper care is taken in alignment with historic preservation needs, including (but not limited to) the stained-glass windows, benches, trees, lighting fixtures, stage, railings, and cupola.

Site Area – Traffic *ALERT*

Permission has been granted by the MVCMA to TRAC, to drive a truck in the reverse direction of traffic along Trinity Park from Jordan Crossing to Pawtucket, if they have an individual standing at the intersection of Pawtucket to hold any vehicles which may be approaching the road. This will expedite the delivery of lumber from the Dukes County Ave storage location to the Tabernacle.

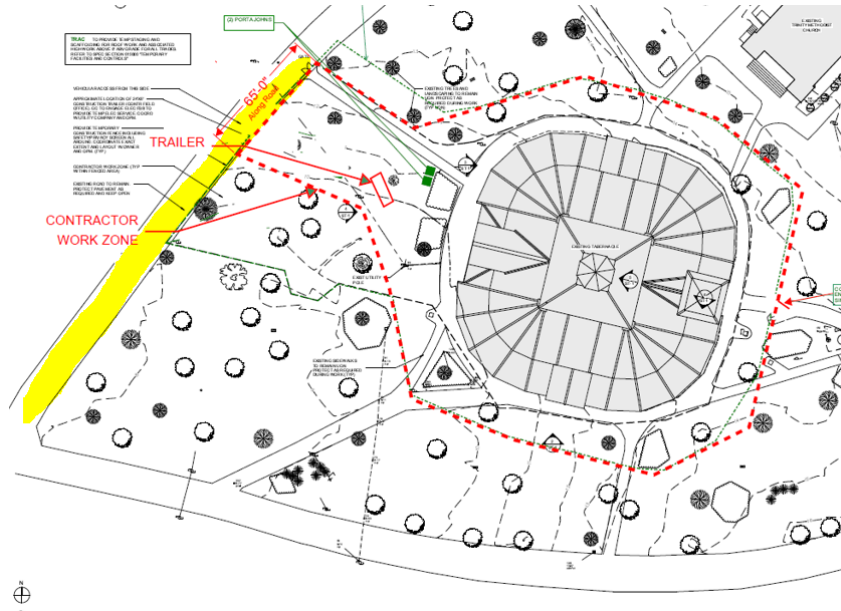

The highlighted area reflects both the area in which TRAC is permitted to drive in reverse, as well as the area which has been designated for them to utilize for any vehicle parking needs. Contractors have been advised that the road must remain unobstructed for regular traffic flow during the entire project.

Site Area – Restrictions and Visitation

Please adhere to all posted signage and stay out of the site area, which is now under the management of TRAC. If you would like to schedule a visit in advance, please contact the Tabernacle Restoration Committee. Safety procedures will be required of any visitor, including wearing high visibility vests and hard hats, as well as proper footwear. A visitor and release waiver may also be required. TRAC has final authority as to who may enter their work site - and visitation may be restricted at their discretion.

Members of the TRC who can be on Island during scheduled meetings with the project team will have access to the site during those times. Additionally, the MVCMA is planning to document the process both with still photograph and film, therefore planned visits with those crews will also be occurring.

Space outside of the fence, including the event tent area, remain accessible to the public.

Communication Updates

All weekly email communications are being uploaded to the MVCMA website and will be available for review under the Project Updates subpage of the Tabernacle section. Additional project updates and

information will be provided via a project website located at TabernacleMV.org. Questions about either website should be directed to Tabernacle@mvcma.org.

Raise Funds, Our Voices, and the Roof

Donations received since June 1 now total \$118,882. Thank you for your incredible support!

A matching opportunity up to \$100,000 remains active for funds given between August 24 and September 30, 2023. This is a great opportunity to double the impact of your donation!

Eligible matching donations have reached \$61,859!

Another way to increase your impact any time of year is to utilize the "Double the Donation" lookup tool located on the MVCMA website to see if your employer matches donations. Visit mvcma.org/support for more information.

Development and fundraising communications should be directed to Development@mvcma.org.

Sincerely,

The Tabernacle Restoration Committee

MVCMA Board Members: Eliza Curtis-Chair, Dave Miller-Vice Chair, Trish Hahn, Kim Jones, Craig Lowe
Non-Board Appointees: Stephen Cofer-Shabica, Russ Dagnall, Ashley Khattach, Dawn McKenna